

ULISSE SERIES

ELECTROMECHANICAL AUTOMATION FOR INDUSTRIAL SECTIONAL DOORS



Opens the future



• A MODEL FOR EVERY NEED.

→ Several versions available: 230 or 400 V, 4 or 6-pole, which allow different door opening and closing speeds on the basis of the weight and dimensions of the same.

→ Several versions available: with chain, fast release, and hold-to-run function (in the version with incorporated control panel).

→ Possible of direct or chain transmission installation.

CODE	DESCRIPTION	VOLTAGE	DOOR WEIGHT
P925188 00002	ULISSE C	230 V	2500 N = 18 m ²
P925188 00003	ULISSE C	400 V	5000 N = 36 m ²
P925188 00004	ULISSE C UP	400 V	5000 N = 36 m ²
P925189 00002	ULISSE SB	230 V	2500 N = 18 m ²
P925189 00003	ULISSE SB	400 V	5000 N = 36 m ²
P925191 00002	ULISSE S C	230 V	3500 N = 25 m ²
P925191 00003	ULISSE S C	400 V	7000 N = 40 m ²
P925191 00004	ULISSE S C UP	400 V	7000 N = 40 m ²
P925192 00002	ULISSE S SB	230 V	3500 N = 25 m ²
P925192 00003	ULISSE S SB	400 V	7000 N = 40 m ²

	TECHNICAL FEATURES			
	ULISSE C/SB 230V	ULISSE C/SB 400V	ULISSE S C/SB 230V	ULISSE S C/SB 400V
CONTROL PANEL	ALPHA FR (suggested)	SIRIO MA (suggested)	ALPHA FR (suggested)	SIRIO MA (suggested)
REVERSIBLE/IRREVERSIBLE OPERATOR	irreversible	irreversible	irreversible	irreversible
POWER SUPPLY	230 V- ± 10%, 50 Hz single-phase	400 V- ± 10%, 50 Hz three-phase	230 V- ± 10%, 50 Hz single-phase	400 V- ± 10%, 50 Hz three-phase
ABSORBED POWER	500 W	770 W	600 W	720 W
THERMAL PROTECTION	integrated	integrated	integrated	integrated
OPENING OR CLOSING TIME	from 17 to 20 s	from 17 to 20 s	from 17 to 20 s	from 17 to 20 s
OUTPUT REVOLUTIONS	22 min	22 min	33 min	33 min
REDUCTION RATIO	1/43	1/43	1/43	1/43
MAX TORQUE	45 Nm	65 Nm	40 Nm	65 Nm
IMPACT REACTION	external active safety edge	external active safety edge	external active safety edge	external active safety edge
TYPE OF LIMIT SWITCHES	electric, incorporated and adjustable	electric, incorporated and adjustable	electric, incorporated and adjustable	electric, incorporated and adjustable
NO. POLES MOTOR	6	6	4	4
THROUGH-SHAFT	Ø 25,4 mm	Ø 25,4 mm	Ø 25,4 mm	Ø 25,4 mm
STROKE	27,5 rpm	27,5 rpm	27,5 rpm	27,5 rpm
DIRECT TAKE-OFF	yes	yes	no	no
OPERATING CYCLE	semi intensive use	semi intensive use	semi intensive use	semi intensive use
ENVIROMENTAL CONDITIONS	from -15°C to + 60°C	from -15°C to + 60°C	from -15°C to + 60°C	from -15°C to + 60°C
DEGREE OF PROTECTION	IP20	IP20	IP20	IP20
OPERATOR WEIGHT	100 N (~10 kg)	100 N (~10 kg)	100 N (~10 kg)	100 N (~10 kg)
DIMENSIONS	see drawing	see drawing	see drawing	see drawing



DIMENSIONS

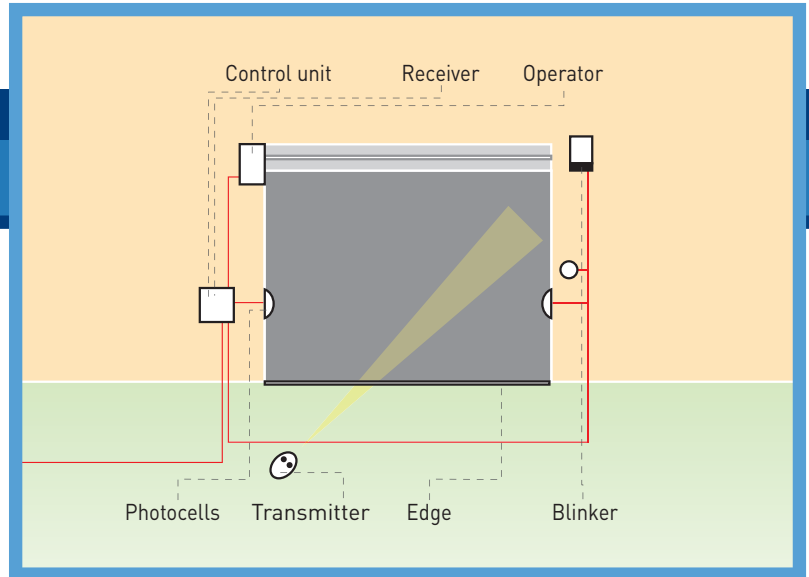
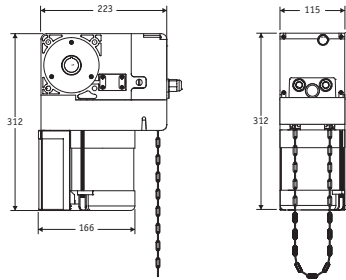

ACCESSORIES



D113200 00001 - SIRIO TMA

• Ideal control panel for a motor of the ULISSE single-phase and three-phase series. • Easy to wire thanks to extractable terminals

and AUTODIAGNOSIS function with LED. • Safety guaranteed by lockable circuit breaker, start-stop buttons, and emergency stop button. • Complete automatic, semiautomatic and hold-to-run operating logics. • Analogue programming for all the operating parameters and the operating logic. **Available while stock last.**



D113713 00002 - SIRIO MA

• Ideal control panel for a motor of the ULISSE single-phase and three-phase series. • Easy to wire thanks to extractable

terminals and AUTODIAGNOSIS function with LED. • Open, Stop and Close buttons • Complete automatic, semiautomatic and hold-to-run operating logics. • Analogue programming for all the operating parameters and the operating logic.



D113689 00002 - ALPHA FR

• Ideal control panel for a motor of the ULISSE single-phase series. • Easy to wire thanks to extractable terminals and

AUTODIAGNOSIS function with LED. • Safety guaranteed by lockable circuit breaker, start-stop buttons, and emergency stop button. • Complete with integrated two-channel receiver and gate open indicator lamp, can manage a second snap-in receiver with advanced function. • Analogue programming for the operating parameters and digital for managing the radio system. • Easy use with previous systems thanks to total compatibility with MIZAR FR.



D113612 00001 - ELMEC 1

• Ideal control unit for a ULISSE single-phase series motor. • Safety guaranteed by Open-Close buttons and emergency

stop button. • Complete with automatic operating logic and semi-automatic when manned.



D113613 00001 - ELMEC 2

• Ideal control unit for a ULISSE three-phase series motor. • Safety guaranteed by Open-Close buttons and emergency stop button.

• Complete with automatic operating logic and semi-automatic when manned.



D533019 - CAP5

5-m open release chain pack for ULISSE C.



D533020 - CAP8

8-m open release chain pack for ULISSE C.



N733336 - PIG 14/ULISSE S

Z14 pinion gear kit for 1/2" x 5/16" chain.



N733337 - PIG 30/ULISSE S

Z30 pinion gear kit for 1/2" x 5/16" chain.



N733338 - PIG 12/ULISSE S

Z12 pinion gear kit for 1/2" x 5/16" chain.



N733339 - PIG 18/ULISSE S

Z18 pinion gear kit for 1/2" x 5/16" chain.



N733148 - COR 30

Z30 crown wheel assembly for 1" (25.4 mm) sectional door shafts, including key and 2m 1/2x5/16" chain. Suitable for sectional

doors with 140 mm cable-winder pulleys.



N733149 - COR 40

Z40 crown wheel assembly for 1" (25.4 mm) sectional door shafts, including key and 2m 1/2x5/16" chain and split link Suitable for sectional doors with 160 mm cable-winder pulleys.



P111407 - FALCON

Industrial presence sensor. Provided with a 6m cable. TELECOMANDO needed for programming.