

OVERALL DIMENSIONS

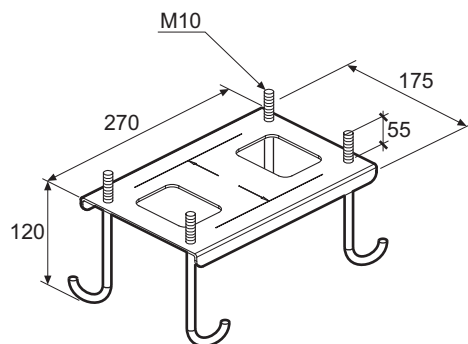

FIXING BASE PLATE
WITH ANCHORING BOLTS

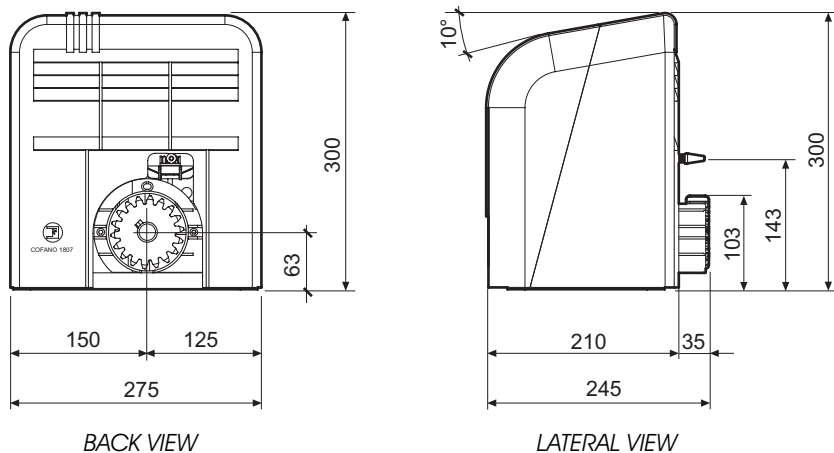

"GIRRI 130" is a very compact geared motor, ideal for small and medium size sliding gates. A specially designed cover, made of heat-resistant material, encloses the pressure cast aluminium gear box, the electric motor, worm gear and the electronic control box.

The electronic control panel is pulse operated through the external accessories: photocells, push buttons, limit switches, remote control, extra command switches and warning lamp; switches are fitted on it to adjust and set the various functions, ie motor run time, dwell time, safety torque control. Moreover "lever switches" allow the selection of the required operating mode from the pre-set programme. A switch cuts off the mains by the removal of the cover, and the low voltage circuit is disconnected by a micro-switch fitted to the operator.

The box which contains the electronics has a transparent plastic lid, easy to reach and remove for servicing.

The operator box, vertical mount only, is designed to stand on a flat base plate fitted with anchor-like long bolts for ground embedding and fixing. It has suitable holes for cable inlet.

The cover assures enough protection both to the moving parts and the electronics being fitted with a lock to prevent misuse by unauthorized people.

The central transmission shaft is of steel, machined to perfectly fit the worm and helical gear. It is supported by bearings and bushes (self-lubrication with grease) that are made of glass fiber.

The helical gear, designed for irreversible motion, is positioned between two toothed shoes, allowing the gear to be brought apart from the driving element simply by unscrewing a screw knob which is co-axial to the shaft. The mechanical limit switch, directly connected to stop micro-switches, comes out of the cover in the shape of a flexible stainless steel rod. This stops the gate when striking suitably designed plates fixed to the toothed bar.

The brake is built in the electric motor and a pre-set programme in the logic card of the operator brakes the unit whenever it reaches the end of the permitted open/close travel.

The choice of the best quality materials, accurate machining, total quality control of the production with modern equipment accounts for the best features of the sliding gate operator "GIRRI 130".

TECHNICAL SPECIFICATIONS

ELECTRIC MOTOR

Power output	0.25KW (0.33HP)
Absorbed power	530W
Supply voltage	230V
Frequency	50Hz
Absorbed current	2.5A
Capacitor	20µF / 450V
Motor rotation speed	1'320 r.p.m.
Intermittent service	S3
Insulation class	F

ELECTRO-MECHANICAL OPERATOR

Type of lubrication	grease
Travel speed	10 m/min.
Rated torque	28.0 Nm
Total operator weight	14 Kg
Maximum gate weight	400 Kg
Gear rating	1/30
Working temperature	-25°C +70°C
Protection standard	IP 535

PERFORMANCE

Service cycle: 30s opening - 30s dwell - 30s closing - 30s dwell	
Complete cycle time	120 s
Complete Opening - Dwell - Closing - Dwell cycles	No.30/hour
Annual cycles (with 8 hours of use per day)	No.87'000



FADINI
the gate opener
Made in Italy



Drwg. No. **1973**

TECHNICAL DATA TABLE

**ELECTRO-MECHANICAL SLIDING
GATE OPERATOR WITH BRAKE**

GIRRI 130

